

New

HIOKI

3454-11

DIGITAL MΩ HiTESTER

Field measuring instruments



Insulation Testing- The Next Generation



with
200mA
continuity



<http://www.hioki.co.jp/>

HIOKI company overview, new products, environmental considerations and other information are available on our website.



3-range

INSULATION & CONTINUITY

New! Sliding Cover System



Back-lighting liquid crystal display for easy reading in dark areas.

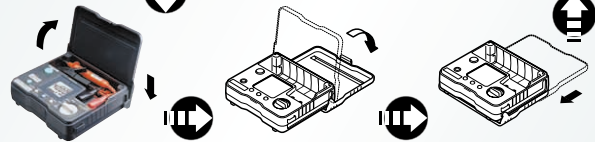

Compact storage without disconnecting test probes

Checks ground wire continuity with a short current of 200 mA

Also capable of testing the continuity of electrical facility grounds in accordance with IEC 60364.

Insulation measurement through sight and sound!

The reference value is set separately for each measurement range.

Function	Reference value
Insulation	250 V/500 V 0.2/0.4/0.5/1/2/3/5/10/20/30/50/100/200 (MΩ)
	1000 V 1/2/3/5/10/20/30/50/100/200/500/1000/2000 (MΩ)
Continuity	0.5/1/2/3/4/5/6/10/20/30/50/100/200/1k (Ω)

Insulation Ω: Meas. value < Ref. value ⇒ FAIL, Ref. value ≤ Meas. value ⇒ PASS
 Continuity: Meas. value ≤ Ref. value ⇒ PASS, Ref. value < Meas. value ⇒ FAIL
 Buzzer can be set to sound on either PASS or FAIL

Ex. Insulation resistance

Buzzer on
FAIL at 20
MΩ or less



Ex. Continuity

Buzzer on
PASS at 10
Ω or less



3454-11 specifications Accuracy at 23°C±5°C (73°F±9°F), 90 % rh or less

Insulation resistance	Insulation test voltage	250 V DC	500 V DC	1000 V DC
	Measurement range*1	4.000 / 40.00 / 400.0 / 500 / 4000(1000 V range only) MΩ		
	1st effective range	0.200 to 50.0 MΩ		0.200 to 200.0 MΩ
	2nd effective range	0 to 0.199 MΩ / 50.1 to 500 MΩ		0 to 0.199 MΩ / 200.1 to 4000 MΩ
	Accuracy	1st effective range: ±3 %rdg, ±4 dgt. / 2nd effective range: ±5 %rdg, ±5 dgt.		
	Voltage with no load	Not more than 1.2 X rated measurement voltage		
	Min. resistance measurement value*2	0.25 MΩ	0.5 MΩ	1 MΩ
	Short circuit current	1.2 mA max.		
	Response time	∞ to center, ∞ to 0 MΩ within 5 s (within accuracy range)		
Low resistance (continuity)	Measurement range: 40.00 / 400.0 / 4.000 k / 40.00 k / 400.0 k / 4.000 MΩ Short circuit current: 200 mA Accuracy: ±3 %rdg, ±6dgt. (±5 %rdg, ±6dgt. at 400 kΩ range or higher) Open terminal voltage: 4 to 6 V Response time: 5 s max.			
AC voltage	Display indication range: 0 to 750 V Accuracy: ±3 %rdg, ±6 dgt.(up to 600V), Frequency range: 50 / 60 Hz, Input impedance: 100 kΩ			

- Other functions: Insulation and low resistance mode - comparator, measurement value hold; Insulation resistance mode - auto discharge; Insulation and AC voltage mode - live wire warning (when voltage of 70V ±10V exists across measurement terminals); Low resistance mode - zero adjust; All measurement modes - battery indicators, auto power save
- Display: Semi-transparent LCD, "4000" count
- Display update rate: 2 times / second
- Load protection(10 s): Insulation resistance mode - 600 Vrms (1000 V range; 1200 Vrms); AC voltage mode - 800 Vrms; Low resistance / continuity mode - 600 Vrms(fuse protection)
- Safety standard: EN61010-1 CAT III 600 V ● EMC standard: EN61326-1 ● Ambient temperature range for use: 0 to 40°C (32°F to 104°F), 90% rh or less (no condensation) ● Ambient temperature range for storage: -20 to 50°C (-4°F to 122°F), 90% rh or less (no condensation)
- Power source: R6P manganese battery X 4 or LR6 alkaline battery X 4
- Dimensions and Mass: Approx. 175 (6.9") W X 148 (5.9") H X 56 (2.3") D mm; Approx. 530 g (18.7 oz.) (with display cover closed)

*1. Measurement range shifts automatically. *2. Resistance value to maintain rated voltage.

Accessories



9294 TEST PROBE Lead length approx. 1.2 m (47.2")

Also available:
 Model *3454-51
 with
 *9289 Test Probe
 and
 *Alligator clips
 as standard accessories
 *No CE marking

Options



Lead length approx. 1.2 m (47.2")
 * 9288 BREAKER PIN To be attached on top of 9294 (Red)
 Lead length approx. 1.3 m (51.1")
 * 9289 TEST PROBE with attachable alligator clips
 * 9257 CONNECTION CORD
 *No CE marking

3454-11 DIGITAL MΩ HITESTER

(Includes 9294 TEST PROBE and Strap band)



HIOKI E. E. CORPORATION

HEAD OFFICE :
 81 Koizumi, Ueda, Nagano, 386-1192, Japan
 TEL +81-268-28-0562 / FAX +81-268-28-0568
 E-mail: os-com@hioki.co.jp

HIOKI USA CORPORATION :
 6 Corporate Drive, Cranbury, NJ 08512 USA
 TEL +1-609-409-9109 / FAX +1-609-409-9108
 E-mail: hioki@hiokiusa.com

Europe Representative Office :
 Meineckstrasse 48, 40474 Dusseldorf, Germany
 TEL / FAX +49-211-4544153
 E-mail: hioki-eu@doitsu.de

Shanghai Representative Office :
 1108 Union Building, 100 Yan An Road (East),
 Shanghai, 200002, P.R.China
 TEL +86-21-6328-9947/4938
 FAX +86-21-6328-2064
 E-mail: hioki-sh@sh.cngb.com

DISTRIBUTED BY